

EQUIP-TEST GROUP

TEST - SUPPORT- INNOVATE



The Company



Fixtures



JIGs



Test Probes



ISP Programmers



In Circuit
Test - Systems



Cable Harness



Interfaces

THE EQUIP-TEST GROUP

Design and Production

Hungary:

EQUIP-TEST Kft.
H-2220 Vecsés



Subsidiaries:

Germany:

EQUIP-TEST GmbH
D-78467 Konstanz

Poland:

EQUIP-TEST Sp. z o.o.
30-198 Kraków

Czech Rep.:

EQUIP-TEST s.r.o.
CZ - 602 00 Brno

Ukraine:

EKIP-TEST
88000 Uzhgorod

Slovakia:

EQUIP-TEST s.r.o.
SK - 821 05 Bratislava

Romania:

ECHIP-TEST s.r.l.
410 605 Oradea

Serbia:

Multi - test doo
21220 Bečej

Bulgaria:

ECHIP-TEST DOO.
1309 Sofia

Asia - Singapore:

EQUIP-TEST ASIA PTE. LTD.
339155 Singapore

CORPORATE HEADQUARTERS



- Located in **Vecsés** (near Budapest Int'l Airport)
- Total Office Space: 1600 m²
- Total Workshop Space: 1600 m²
- Total Warehouse Space: 800 m²
- No. of Employees: 120
 - 50 in Sales/Office
 - 70 in Workshop
- Managing Directors:
 - Csaba Kádár
 - Zoltán Kádár

ICT-FIXTURES

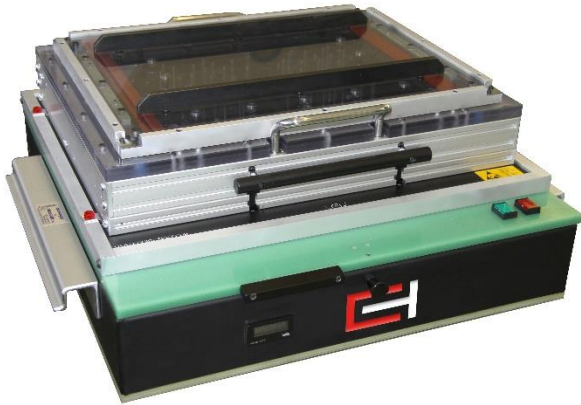

Marconi



Genrad

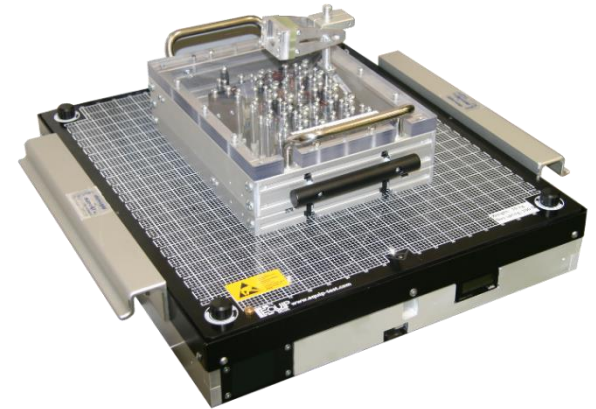

Keysight 3070

Main features of our ICT Fixtures

- Vacuum and manual fixtures
- Single or Dual Well (Tandem)
- Bottom-side or Double-sided Access (T/B)
- Quick Exchange Kits
- Self – Opening Covers
- Side contacting Units



Teradyne

MECHANICAL FIXTURE KITS



MFS-D2

- External Dimension (width x deep x height) with Handles:
409 mm x 554 mm x 280 mm
[16.102 in x 21.811 in x 11.024 in]
- Usable Area:
133 mm x 218 mm [5.236 in x 8.583 in]
- Maximum Force: 1000N
- Exchangeable Kit: **EXCH-D2-PYL**



MFS-D3

- External Dimension (width x deep x height) with Handles:
549 mm x 605 mm x 280 mm
[21.614 in x 23.819 in x 11.024 in]
- Usable Area:
273 mm x 218 mm [10.748 in x 8.583 in]
- Maximum Force: 1000N
- Exchangeable Kit: **EXCH-D3-PYL**



MFS-D4

- External Dimension (width x deep x height) with Handles:
729 mm x 674 mm x 280 mm
[28.701 in x 26.535 in x 11.024 in]
- Usable Area:
433 mm x 288 mm [17.047 in x 11.339 in]
- Maximum Force: 1000 N
- Exchangeable Kit: **EXCH-D4-PYL**

MECHANICAL FIXTURE KITS



MFT-D4

- External Dimension (width x deep x height)
with Handles:
729 mm x 674 mm x 280 mm
[28.701 in x 26.535 in x 11.024 in]
- Usable Area:
433 mm x 288 mm [17.047 in x 11.339 in]
- Maximum Force: 1000 N
- Exchangeable Kit (2x): **EXCH-D2-PYL**



HPS-25

- External Dimension (width x deep x height):
300 mm x 380 mm x 200 mm
[11.811 in x 14.961 in x 7.874 in]
- Usable Area:
200 mm x 125 mm [7.874 in x 4.921 in]
- Maximum Force: 300N
- Exchangeable Kit:
EXCH-HPS-25 - Bakelite Probe Plate
EXCH-HPS-25-ESD - ESD Painted FR-4 Probe Plate

Equip-Test R&D department has designed a new **Hand Press Fixture** for low pin-count applications. Ideal for flash programming, rework purposes. Due to its high-tech design, it can be also customized for either top or bottom connecting. As it has an exchangeable kit feature, it is perfect solution for small, middle batch and/or high-mix productions.

CUSTOMIZED MECHANICAL FIXTURE KITS



FUNCTIONAL TEST FIXTURES

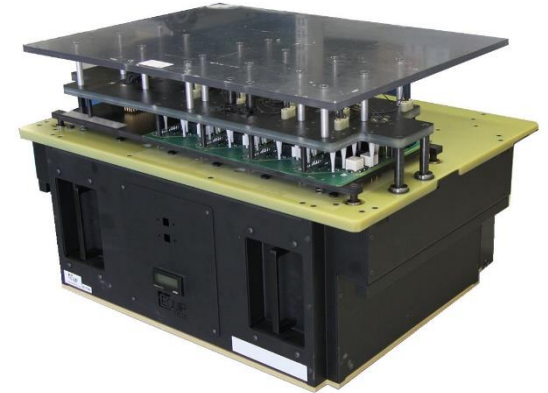

TEST PLATFORM **TRIO 100 M**

The main highlights of the new TRIO Platform includes the single or dual access Equip-Test Mechanical Test Fixture (MFS), the fast TRI Tiny SII ICT and the reliability of the VPC G12 Interface Connectors.

The combination of these 3 main features together with the renowned Equip-Test ICT engineering knowledge ensures that you can get a very good start-off ICT Test System for analog and digital measurements.

ALL SYSTEMS FEATURES :

- 19" Rack with monitor holder, 19" monitor, keyboard holder and keyboard with integrated mouse, 2 blowers, UPS
- TRI 5001T SII Tiny ICT Mainset, keybox
- ESD plug GS703



OPTIONAL TINY CONTROL SOFTWARES FOR:

- Toellner Power Supply
- FEASA LED Analyzer
- Cover Closed Sensor
- Pneumatic Cylinders
- OMRON Camera for Dimension Measurement
- Cover lock solenoid
- Algocraft programmer
- Flashrunner programmer
- PASS printer

and DLL call for LIN communication



OPTIONAL HARDWARES:

- Side shelf
- Error Printer STAR SP712 *
- Label Printer SATO CG212 DT/TT *
- Honeywell 1400G handheld scanner + holder

*the side shelf is also needed

TEST PROBES FOR ELECTRONICS INDUSTRY

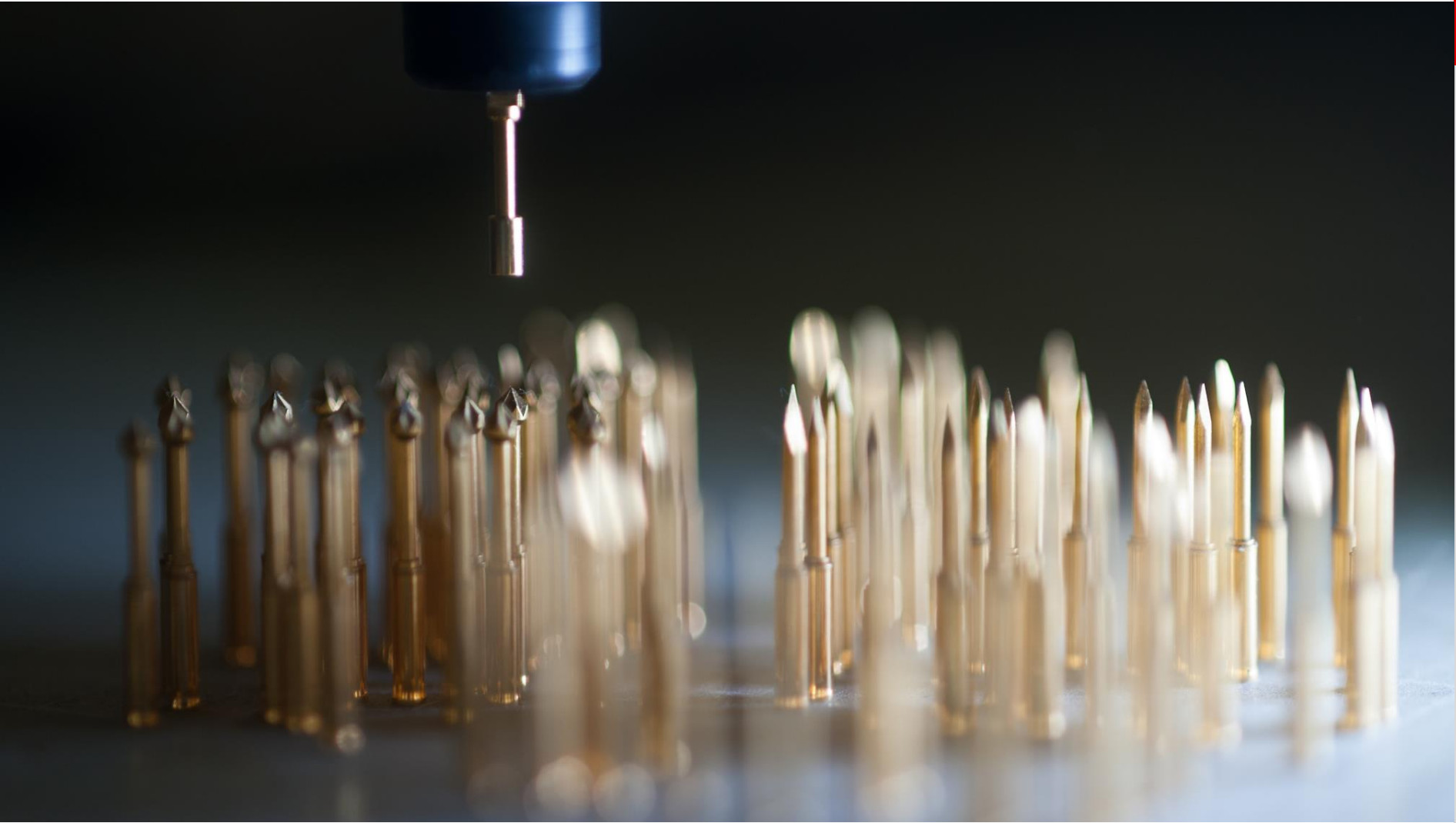

TEST PROBES FOR ELECTRONICS INDUSTRY

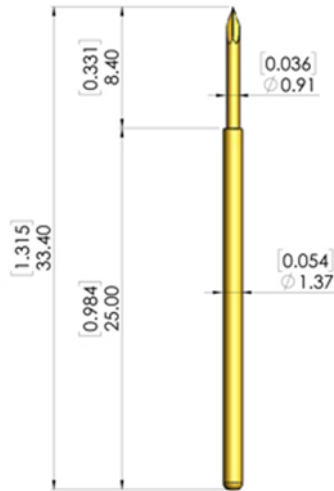

**LF - Lead-free
Test Probes**

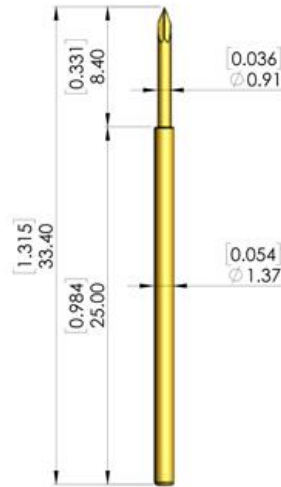

**ST - ICT
Test Probes**

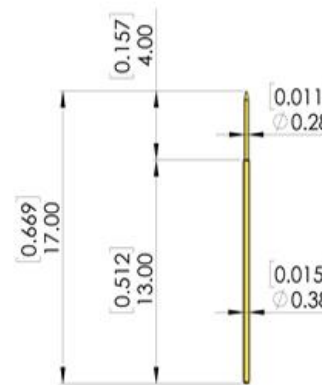

**MP - Micro
Probes**

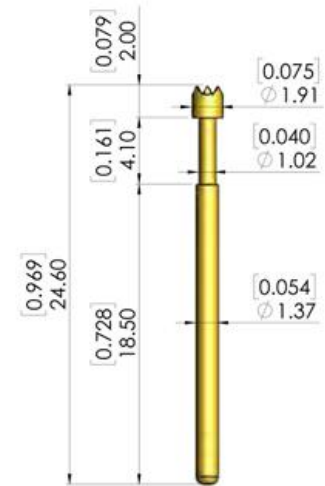

**ST - Multi-propose
Test Probes**

TEST PROBES FOR ELECTRONICS INDUSTRY

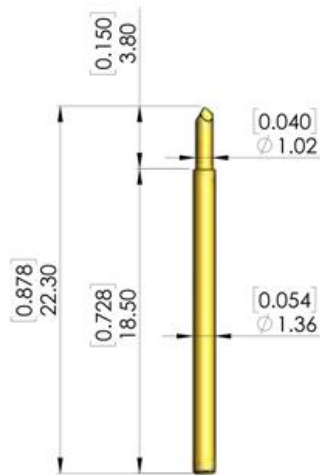

IT - Interface Probes

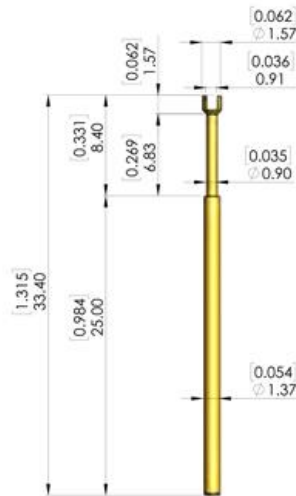

FC - Fixture Customizing Probes

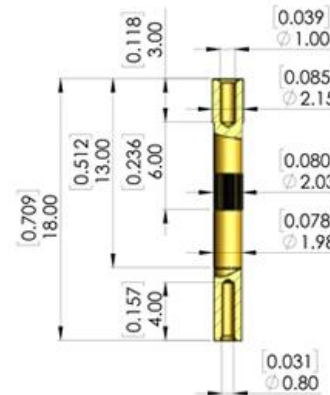

IC - Interface Contacts

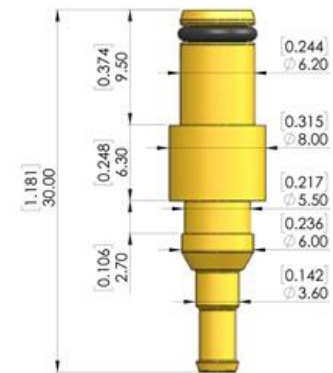

PIC - Pneumatic Interface Contacts

TEST PROBES FOR ELECTRONICS INDUSTRY

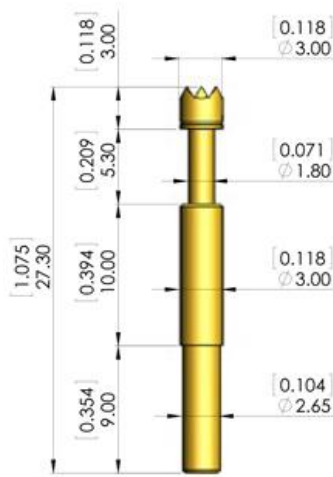

HC - High-Current Probes

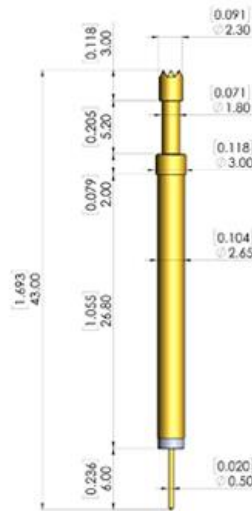

SW - Switch Probes

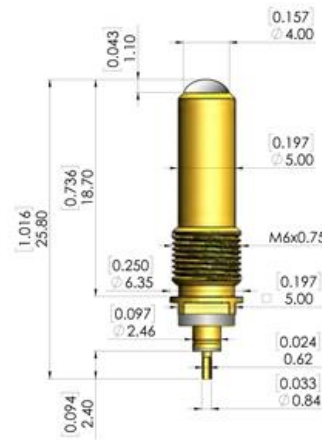

Ball - Headed Switch Probes



PN - Pneumatic Test Probes

TEST PROBES FOR ELECTRONICS INDUSTRY

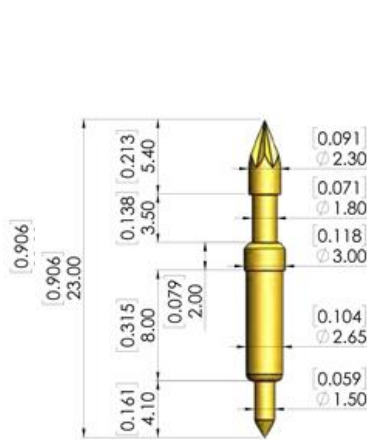

BP – Battery Probes

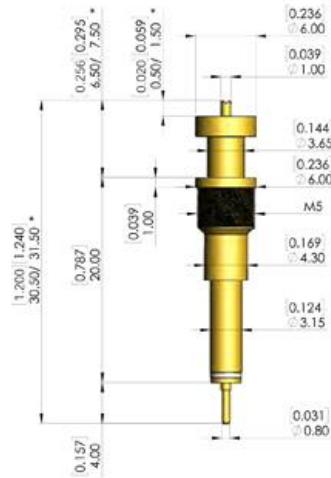

KP – Kelvin Test Probes



RF – Radio Frequency Test Probes

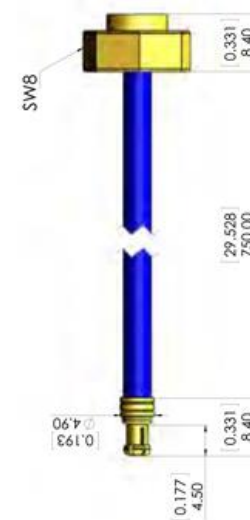

RF – Cable Confection



Custom RF Cable Assemblies

TEST PROBES FOR ELECTRONICS INDUSTRY

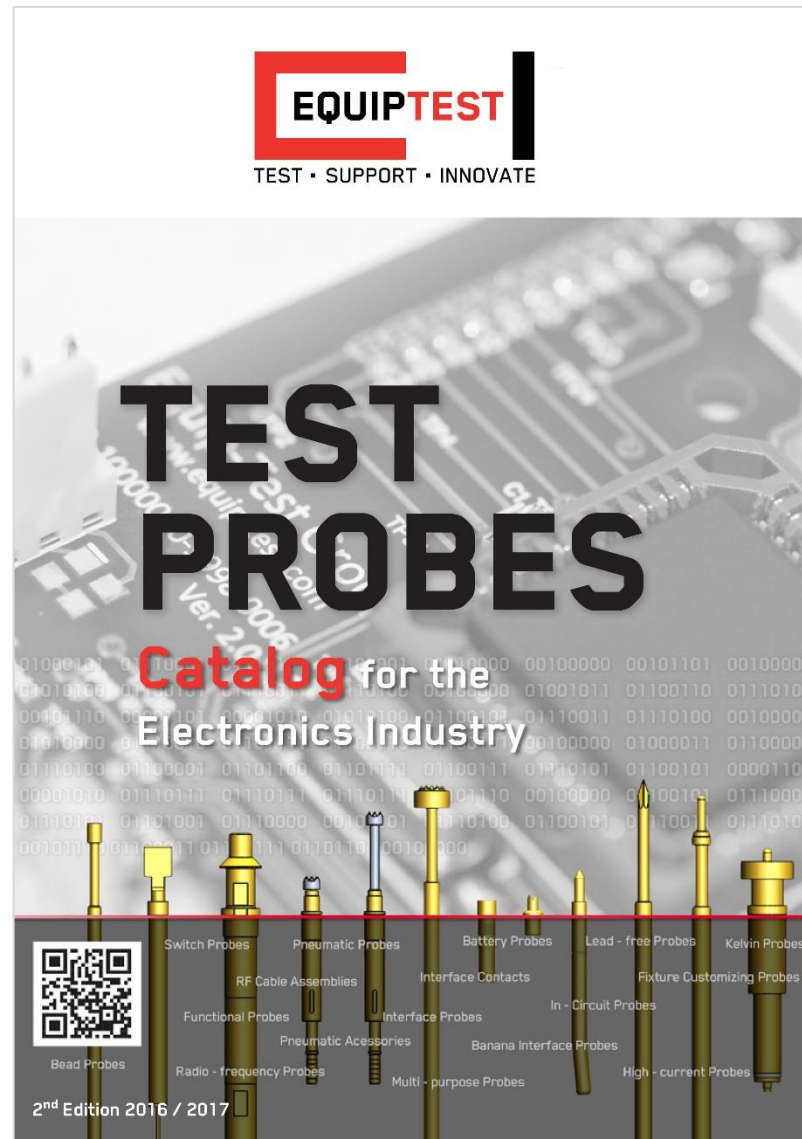

JIGS / TEST CONNECTORS

HIGH QUALITY, ROBUST, INDUSTRIAL DESIGN FOR FUNCTIONAL-, EOL AND LIFE-CYCLE-TESTS



JIGS / TEST CONNECTORS

- Longlife - Expectancy due to materials, which are especially resistant to dust, grease, oil or other contaminants
- Easy to repair and maintain due to Modular Design
- Customized with Spring Test Probes
- For Functional Test, EOL - Test, Programming, Failure Analysis
- The alternative to the original - Mating Connector
- Universally applicable
- Customer Specific Design

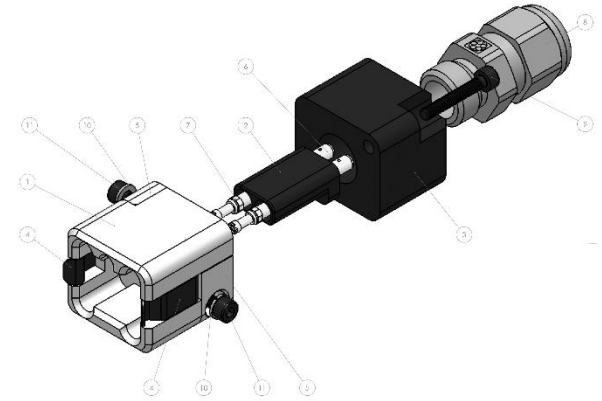

WE PROVIDE:

- Clip-Test
- Push-Back Test (zero force)
- Sealing and Continuity Test
- Short-Circuit Test
- Colour and Code Identification Test
- Presence and Shape Test of Components and Pins
- Switch Status and Condition Test
- Module Parts and Release Switch



TEST MODULES & TESTERS

MCT100

Test Modules designed and manufactured by Equip-Test fit to most manufacturer's **Test Tables / Test Benches**.

We manufacture:

- Standard Modules for open / short test
- Push-back Modules
- Leakage Test Modules
- Special Solutions as well.



MCT100 Cable Harness Test System is an ideal choice for small and medium size cable harness manufacturers.

Features:

- **Test Points Number:** 2 x 64 pcs, expandable up to 2 x 128 TP's (64 measuring point /connector)
- **Test Connector:** DIN 41642, Type C
- **Measuring Voltage:** 5V (measuring current: < 1mA)
- **Interface for PC:** USB (for optional PC Software)
- ESD protection at all test points
- **Size (mm):** 440 x 135 x 300 (W x H x D), without handles on the front panel



CABLE HARNESS TESTER

Equip - Test has launched this new **Cable - Harness Test System** for high - end users with high pin count cable - harnesses.

Features:

- Data transfer from/to the PC via USB or Ethernet
- Continuity Test and Short-Circuit Test
- Testing of resistors, diodes
- Plug-in slots for 4 internal test point cards, up to 512 internal test points
- Expandable up to 2048 test points with module - MCE001
- Standard mini-PC as a basis
- Complete equipment with standard interfaces in the back panel: (keyboard, mouse, USB, serial port, parallel port, Ethernet, VGA)
- Frontplate fitted with navigation keyboard, pin probe and USB
- Casing with integrated power supply and fan
- Programming according to „golden samples“
- Programming with the testing software Equip-Test MCT
- PIN probe function
- Recording of measuring results
- Arbitrarily programmable inputs and outputs (16/16)
- Support of bar code reader
- Support of label printer
- Hardware key authentication (iButton)



Technical Data:

- **Test Points:** up to 512 internal, up to 2048 total
- **Test Current:** 20 mA
- **Test Voltage:** 5 V
- **Threshold Resistance:** $185 \Omega \pm 5\%$
- **Resistor Measurement:** 10Ω to 200 k Ω , accurately 3%
- **Diode Test:** polarity, forward voltage, reverse (up to 2V)
- **Digital Output:** 16x max. 750 mA
- **Digital Input:** 16x 24V
- **Industrial PC** with 120 GB SSD SATA Drive
- **Interfaces:** 3 USB, 1 Ethernet, 1 VGA, 1 RS232, 1 LPT
- **Dimensions (mm):** 440 x 135 x 440 [W x H x D]

INTERFACES & MODULES

- Signal, Power, Coax and Pneumatic Contacts
- High quality product standards required for reliable testing methods
- Precisely fitted to ensure exact and reliable contact

SIGNAL

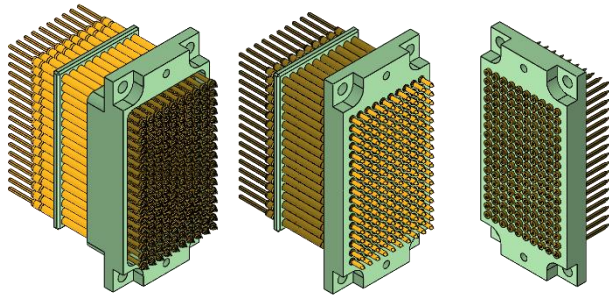

As ITA / Receiver to connect the Test Fixture
in universal ICT and Functional - Test Systems

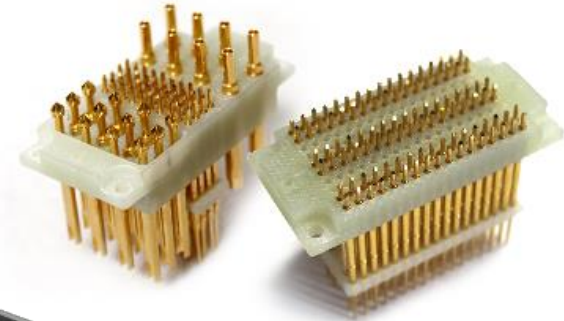

POWER

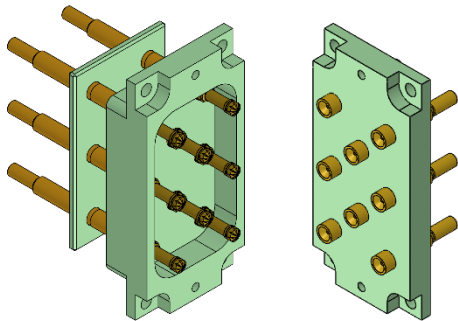

High Current / Power for
Functional - Test Systems

PNEUMATIC

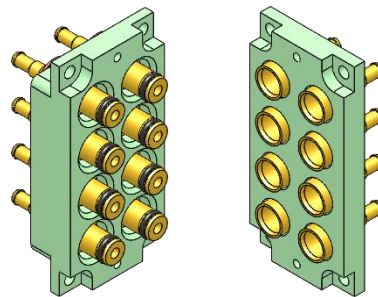

MIXED

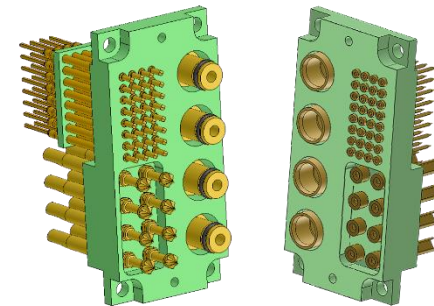

IN-SYSTEM PROGRAMMERS (ISP)



KEY FEATURES

- Ultra-fast, universal In-System Programmers True - parallel, program up to 8 devices at once
- Industrial-grade reliability
- Standalone operations or host controlled
- Easy to install and to use
- Compact size, fixture friendly

APPLICATIONS

- On-board programming for Automatic Test Equipment
- On-board programming for standalone stations
- Functional test
- Automotive





**THANK YOU
FOR YOUR ATTENTION !**